

FIRST FLOOR - DEMOLITION PLAN  
3/32" = 1'-0"

**DEMOLITION PLAN LEGEND**  
APPLIES TO DRAWINGS A1.2.1 - A1.2.2

- EXISTING PARTITION/WALL/ITEM TO REMAIN
- REMOVE EXISTING PARTITION/WALL/ITEM
- REMOVE EXISTING WINDOW ASSEMBLY AND FRAMING, INCLUDING ANCHORS
- REMOVE EXISTING DOOR AND FRAME ASSEMBLY INCLUDING DOOR HARDWARE, ANCHORS, AND THRESHOLD (WHERE OCCURS).
- REMOVE EXISTING PLUMBING FIXTURE. REFER TO PLUMBING DEMOLITION PLAN FOR ADDITIONAL INFORMATION.

**DEMOLITION PLAN GENERAL NOTES**

- A. FIELD VERIFY ALL EXISTING CONDITIONS AND DIMENSIONS INDICATED ON THE DRAWINGS. COORDINATE THE SCOPE, DIMENSIONS, AND EXTEND OF DEMOLITION WORK TO BE PERFORMED WITH THE WORK.
- B. PLAN DIMENSIONS FOR EXISTING CONDITIONS ARE TO FACE OF FINISH OR CENTERLINE OF STRUCTURAL FRAMING, UNLESS OTHERWISE NOTED. THICKNESS OF MASONRY BASED ON NOMINAL SIZES. ALL DIMENSIONS SHOW FOR EXISTING CONSTRUCTION ARE APPROXIMATE.
- C. ALL EXPOSED SURFACES AFFECTED BY THE DEMOLITION WORK AND WHICH SHALL REMAIN EXPOSED TO VIEW SHALL BE PATCHED TO MATCH EXISTING ADJACENT SURFACES UNLESS SPECIFICALLY INDICATED OTHERWISE.
- D. ACTUAL FIELD CONDITIONS WHICH ARE CONCEALED BY EXISTING CONSTRUCTION MAY VARY FROM THOSE INDICATED ON THE DRAWINGS.
- E. PRIOR TO DEMOLITION, COORDINATE WITH OWNER SCHEDULES FOR THEIR TEMPORARY RELOCATION OF EXISTING EQUIPMENT IN WORK AREAS.
- F. REMOVE ALL CEILING GRID, ALL ASSOCIATED CEILING GRID COMPONENTS AND ALL CEILING MOUNTED DEVICES, UNO
- G. REMOVE AND SAVE FOR REINSTALLATION ALL PORTABLE FIRE EXTINGUISHERS.
- H. REMOVE ALL COVE BASE FROM CASEWORK AND MILLWORK
- I. PROTECT ALL CASEWORK FROM DAMAGE
- J. REMOVE ALL CEILING MOUNTED EMERGENCY SHOWERS
- K. REMOVE ALL INTERIOR SIGNAGE
- L. REMOVE ALL WINDOW SHADES
- M. REMOVE AND SALVAGE ALL CEILING MOUNTED PROJECTORS
- N. REMOVE AND SALVAGE ALL MOTORIZED PROJECTION SCREENS
- O. REMOVE ALL VCT FLOORING, ADHESIVE AND WALL BASE
- P. REMOVE GLUE RESIDUE FROM OFFICE FLOORS
- Q. REMOVE ALL GYPSUM WALLBOARD TO 3/8" AFF. ONCE INTERIOR OF WALL IS EXPOSED, REMOVE ALL GYPSUM WALLBOARD TO THE EXTENT THAT SIGNS OF MOLD ARE PRESENT
- R. REMOVE ALL VINYL AND CARPET WALLCOVERING, ADHESIVE AND WALL BASE.
- S. REMOVE OR OBSCURE STENCILLED WORDING ABOVE CEILING WHICH INDICATES THE WALL IS A FIRE RATED ASSEMBLY.
- T. REMOVE ALL INTERIOR WOOD TRIM FROM DOORS AND WINDOWS

**DEMOLITION GENERAL NOTES - ALTERNATES**

- 1A. (ALTERNATE 1) REMOVE ALL SHEET FLOORING, WALL BASE AND ADHESIVE.
- 2A. (ALTERNATE 2) REMOVE ALL WALL MOUNTED SINKS FROM MEN'S AND WOMEN'S RESTROOMS.
- 4A. (ALTERNATE 2) REMOVE ALL WALL MOUNTED MIRRORS FROM MEN'S AND WOMEN'S RESTROOMS
- 2A. (ALTERNATE 3) REMOVE ALL TOILET PARTITIONS FROM MEN'S AND WOMEN'S RESTROOMS.
- 3A. (ALTERNATE 3) REMOVE ALL TOILETS AND URINALS FROM MEN'S AND WOMEN'S RESTROOMS.

**DEMOLITION PLAN KEYNOTES**  
REPRESENTED BY [A]  
APPLIES TO DRAWINGS A1.2.1a - A1.2.2a

- 11 REMOVE FUME HOOD BASE CABINETS AND EPOXY TOP
- 12 REMOVE CASEWORK, EPOXY TOPS AND CABINETS
- 13 REMOVE PORTION OF WALL TO SUIT NEW OPENING
- 14 REMOVE ROLLING SHUTTER AND SILL

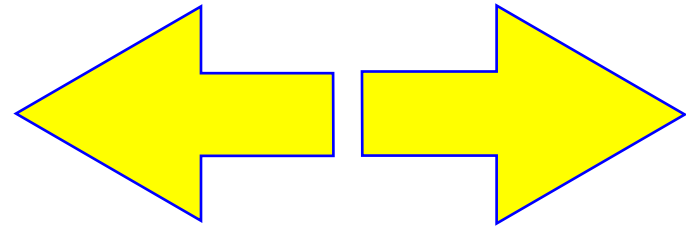
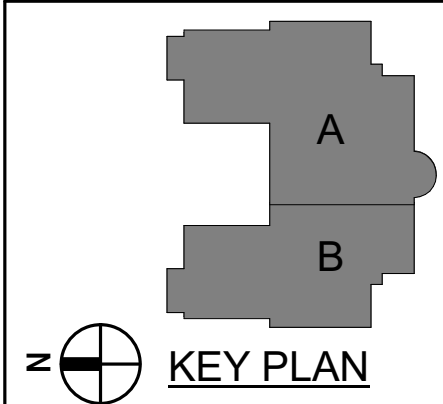

PROJECT NO.	DATE
580999	MARCH 27, 2019
REVISIONS	
DATE	DESCRIPTION